



## 2 bed end of terrace house to buy in NG16

Chewton Street, Eastwood, Nottingham, Nottinghamshire, NG16 3JN

**£90,000** Starting Bid

🏠 x2 🚗 x1 🚻 x2

Tenure

**Freehold**

On Street parking

## Property features

- ✓ Being Sold via Secure Sale online bidding. Terms & Conditions apply.
- ✓ Immediate 'exchange of contracts' available
- ✓ End Terrace House
- ✓ Two Reception Rooms
- ✓ EPC Rating D

## Key Information

- ✓ Council Tax: Band A
- ✓ EPC Rating: D
- ✓ Heating supply: Gas
- ✓ Electric supply: National Grid
- ✓ Water supply: Direct mains water
- ✓ Broadband: FTTC (fibre to the cabinet)
- ✓ Mobile signal: Good

## Description

Being sold via Secure Sale online bidding. Terms & Conditions apply.

This two bedroom end terrace house having double glazing and gas central heating is idea for an extension and renovation to give the property more living accommodation.. The accommodation comprises of lounge, dining room and kitchen to the ground floor. Two bedrooms and bathroom to the first floor. ( Please note, access to bedroom one and the bathroom is via bedrooms two). Outside there is an enclosed garden to the rear. Viewing is strongly recommended to see the potential this property has to offer.

### Auctioneers Additional Comments

Pattinson Auction are working in Partnership with the marketing agent on this online auction sale and are referred to below as 'The Auctioneer'.

This auction lot is being sold either under conditional (Modern) or unconditional (Traditional) auction terms and overseen by the auctioneer in partnership with the marketing agent.

The property is available to be viewed strictly by appointment only via the Marketing Agent or The Auctioneer. Bids can be made via the Marketing Agents or via The Auctioneers website.

Please be aware that any enquiry, bid or viewing of the subject property will require your details being shared between both any marketing agent and The Auctioneer in order that all matters can be dealt with effectively.

The property is being sold via a transparent online auction.

In order to submit a bid upon any property being marketed by The Auctioneer, all bidders/buyers will be required to adhere to a verification of identity process in accordance with Anti Money Laundering procedures. Bids can be submitted at any time and from anywhere.

Our verification process is in place to ensure that AML procedure are carried out in accordance with the law.

The advertised price is commonly referred to as a Starting Bid or Guide Price and is accompanied by a Reserve Price. The Reserve Price is confidential to the seller and the auctioneer and will typically be within a range above or below 10% of the Guide Price / Starting Bid.

These prices are subject to change.

An auction can be closed at any time with the auctioneer permitting for the property (the lot) to be sold prior to the end of the auction.

#### Auctioneers Additional Comments

An auction can be closed at any time with the auctioneer permitting for the property (the lot) to be sold prior to the end of the auction.

A Legal Pack associated with this particular property is available to view upon request and contains details relevant to the legal documentation enabling all interested parties to make an informed decision prior to bidding. The Legal Pack will also outline the buyers obligations and sellers commitments. It is strongly advised that you seek the counsel of a solicitor prior to proceeding with any property and/or Land Title purchase.

In order to secure the property and ensure commitment from the seller, upon exchange of contracts the successful bidder will be expected to pay a non-refundable deposit equivalent to 5% of the purchase price of the property. The deposit will be a contribution to the purchase price. A non-refundable reservation fee of up to 6% inc VAT (subject to a minimum of 6,000 inc VAT) is also required to be paid upon agreement of sale. The Reservation Fee is in addition to the agreed purchase price and consideration should be made by the purchaser in relation to any Stamp Duty Land Tax liability associated with overall purchase costs.

Both the Marketing Agent and The Auctioneer may believe necessary or beneficial to the customer to pass their details to third party service suppliers, from which a referral fee may be obtained. There is no requirement or indeed obligation to use these recommended suppliers or services.

Council Tax Band: A

Tenure: Freehold

Price: Starting Bid £90,000

Property Type: End of terrace house

Parking: On Street

Construction materials: Brick and block

Roofing type: Slate tiles

Risk of floods and or erosion: No

Flooded in last 5 years: No

Flood defences: No

Planning permissions or proposals for development: No

Coalfield or mining area: No

Listed property: No

Conservation area: No

Public rights of way: No

Adaptions for accessibility: No

Restrictions: No

Required access: No

Heating: Gas

Electric: National Grid

Water: Direct mains water

Sewerage: Standard UK domestic

Air conditioning: No

Broadband: FTTC (fibre to the cabinet)

Mobile signal coverage: Good

## Lounge

3.89m x 3.53m (12'9" x 11'6")

upvc door to the front elevation and double glazed window to the front elevation. Laminate floor covering. Central heating radiator. Door leading to the dining room.

---

## Dining Room

3.38m x 3.33m (11'1" x 10'11")

Double glazed window to the rear elevation, storage cupboard. Central heating radiator. Staircase to the first floor. Central heating radiator. Door to the kitchen.

---

## Kitchen

2.97m x 2.26m (9'8" x 7'4")

Double glazed window to the side elevation, door to the side leading to the rear garden. The kitchen comprises of stainless steel sink unit with side drainer inset into roll edge work surfaces, a range of base and wall units, built on oven, hob and extractor hood. Plumbing for automatic washing machine.

---

## Bedroom 1

3.33m x 3.33m (10'11" x 10'11")

Double glazed window, central heating radiator. Door to the bathroom and door to the bedroom

---

## Bedroom 2

3.78m x 3.35m (12'4" x 10'11")

Double glazed window , storage cupboard and central heating radiator.

---

## Bathroom

Double glazed window. White suite comprising of panelled bath with shower over, pedestal wash hand basin and low flush wc. Central heating radiator.

---

## Outside

Enclosed garden to the rear with patio area, artificial lawn area and outbuildings.

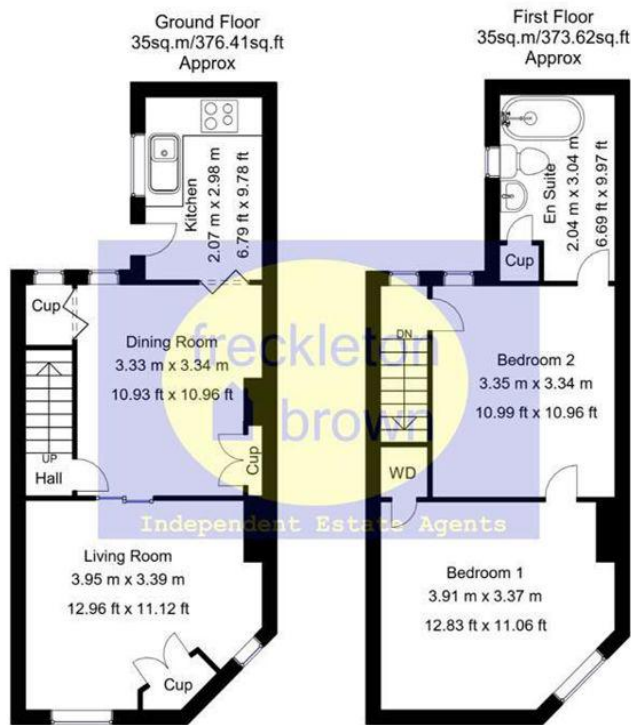

Whilst every attempt has been made to ensure the accuracy of the floor plan contained here, no responsibility is taken for incorrect measurements of doors, windows, appliances and room or any error, omission or misstatement. Exterior and interior walls are drawn to scale based on interior measurements. Any figure given is for initial guidance only and should not be relied on as basis of valuation. These plans are for marketing purposes only and should be used as such by any prospective purchase. Specially no guarantee is should not be relied on as a basis of valuation. These plans are for marketing purposes only and should be used as such by any prospective purchase. Specially no guarantee is given on the total square footage of the property if quoted on this plan.  
CC Ltd ©2018

Energy Efficiency Rating		
	Current	Potential
<i>Very energy efficient - lower running costs</i>		
(92-100) <b>A</b>		
(81-91) <b>B</b>		
(69-80) <b>C</b>		77
(55-68) <b>D</b>	61	
(39-54) <b>E</b>		
(21-38) <b>F</b>		
(1-20) <b>G</b>		
<i>Not energy efficient - higher running costs</i>		
<b>England, Scotland &amp; Wales</b>	EU Directive 2002/91/EC	

Chewton Street, Eastwood, Nottingham, Nottinghamshire, NG16 3JN

Contact your local branch today for more information on this property:

**1 1, 1, 1, 1, [www.bella-properties.co.uk](http://www.bella-properties.co.uk)**

These particulars, whilst believed to be accurate are set out as a general outline only for guidance and do not constitute any part of an offer or contract. Intending purchasers should not rely on them as statements of representation of fact, but must satisfy themselves by inspection or otherwise as to their accuracy. No person in this firms employment has the authority to make or give any representation or warranty in respect of the property.

